

DATE: \_\_\_\_\_ CUSTOMER NAME: \_\_\_\_\_ PHONE: \_\_\_\_\_  
 EMAIL: \_\_\_\_\_ WHEN DO YOU WANT TO PICK-UP? \_\_\_\_\_

**DOOR CLEARANCE CENTER**

# SENTRY Cabinet Order Form

- All plywood, no particle board
- In stock in our warehouse, allow approx. 2-3 days to pull order
- RTA - ready to assemble
- Soft close doors & drawers
- Premium factory finish
- Full overlay

**\$1,498!**  
10x10 SET



**SHAKER WHITE**



**SHAKER GRAY**



Wall Cabinet – 1 DOOR				Qty
9" x 30"	#W930	<b>A</b>	\$71	
12" x 30"	#W1230	<b>B</b>	\$67	*
15" x 30"	#W1530	<b>C</b>	\$96	
18" x 30"	#W1830	<b>D</b>	\$89	**
21" x 30"	#W2130	<b>E</b>	\$124	
<hr/>				
9" x 36"	#W936	<b>WA</b>	\$71	
12" x 36"	#W1236	<b>WB</b>	\$83	
15" x 36"	#W1536	<b>WC</b>	\$96	
18" x 36"	#W1836	<b>WD</b>	\$110	
21" x 36"	#W2136	<b>WE</b>	\$124	
9" x 42"	#W942	<b>UA</b>	\$106	
12" x 42"	#W1242	<b>UB</b>	\$124	
15" x 42"	#W1542	<b>UC</b>	\$142	
18" x 42"	#W1842	<b>UD</b>	\$161	
21" x 42"	#W2142	<b>UE</b>	\$179	



Wall Cabinet – 2 DOORS				Qty
24" x 30"	#W2430	<b>F</b>	\$141	
30" x 30"	#W3030	<b>H</b>	\$168	
36" x 30"	#W3630	<b>J</b>	\$158	*
24" x 36"	#W2436	<b>WF</b>	\$141	
30" x 36"	#W3036	<b>WH</b>	\$168	
36" x 36"	#W3636	<b>WJ</b>	\$197	
24" x 42"	#W2442	<b>UF</b>	\$209	
30" x 42"	#W3042	<b>UH</b>	\$245	
36" x 42"	#W3642	<b>UJ</b>	\$284	



Wall Bridge Cabinet				Qty
30" x 12"	#W3012	<b>K</b>	\$64	*
36" x 12"	#W3612	<b>L</b>	\$74	*
30" x 18"	#W3018	<b>WK</b>	\$78	
36" x 18"	#W3618	<b>WL</b>	\$91	
30" x 24"	#W3024	<b>UK</b>	\$146	
36" x 24"	#W3624	<b>UL</b>	\$187	



Refrigerator Wall Cabinet – 24" DEEP				Qty
36" x 18"	#WR3618	<b>UM</b>	\$128	
36" x 24"	#WR3624	<b>UN</b>	\$168	



Diagonal Wall Corner Cabinet				Qty
24" x 30"	#DW2430	<b>O</b>	\$152	*
24" x 36"	#DW2436	<b>WO</b>	\$189	
24" x 42"	#DW2442	<b>UO</b>	\$238	

◊ Reversible 39" wide cabinet. Install 3"-6" away from wall for a 42"-45" wide space.

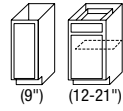

Base Cabinet – 1 DOOR				Qty
9"	#B9	<b>P</b>	\$79	*
12"	#B12	<b>Q</b>	\$150	
15"	#B15	<b>R</b>	\$134	*
18"	#B18	<b>S</b>	\$147	*
21"	#B21	<b>T</b>	\$199	

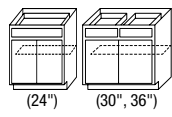

Base Cabinet – 2 DOORS				Qty
24"	#B24-2	<b>U</b>	\$220	
30"	#B30	<b>W</b>	\$261	
36"	#B36	<b>X</b>	\$295	



Drawer Base Cabinet				Qty
12"	#DB12	<b>YJ</b>	\$200	
15"	#DB15	<b>YA</b>	\$258	
18"	#DB18	<b>YB</b>	\$280	
24"	#DB24	<b>YC</b>	\$321	
30"	#DB30	<b>YK</b>	\$360	



Sink Base Cabinet				Qty
30"	#SB30	<b>YD</b>	\$186	
36"	#SB36	<b>YE</b>	\$173	*



Blind Base Cabinet				Qty
42"-45"	#BBC42	<b>YF</b>	\$278	◊



Base Corner Cabinet – LAZY SUSAN				Qty
36"	#LS36	<b>YG</b>	\$272	*

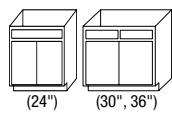

Vanity Sink Base Cabinet				Qty
24" x 21"	#V2421	<b>VB</b>	\$153	
30" x 21"	#V3021	<b>VC</b>	\$179	
36" x 21"	#V3621	<b>VD</b>	\$207	



Vanity Sink Base Deluxe Cabinet				Qty
36" x 21"	#VSD3621	<b>VE</b>	\$331	



Vanity Drawer Base Cabinet				Qty
12" x 21"	#VDB1221	<b>VA</b>	\$219	

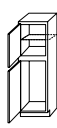

Tall Pantry Cabinet				Qty
18" x 84"	#P1884	<b>YH</b>	\$366	
18" x 90"	#P1890	<b>YL</b>	\$405	
18" x 96"	#P1896	<b>YM</b>	\$439	

**Accessories**

Accessories				Qty
3" x 30" Filler	#F330	<b>ZA</b>	\$11	
3" x 42" Filler	#F342	<b>ZM</b>	\$16	
6" x 30" Filler	#F630	<b>ZB</b>	\$23	
6" x 42" Filler	#F642	<b>ZN</b>	\$31	
3" x 96" Tall Filler	#F396	<b>ZC</b>	\$36	
8' Toe Kick	#TK8	<b>ZD</b>	\$11	
8' Scribe Moulding	#SM8	<b>ZE</b>	\$14	
8' Shoe Moulding	#SH8	<b>ZF</b>	\$9	
8' Crown Moulding	#CM8	<b>ZG</b>	\$44	
8' Outside Corner Moulding	#OCM8	<b>ZH</b>	\$14	
8' Inside Corner Moulding	#ICM8	<b>ZJ</b>	\$14	
3" Dishwasher End Panel	#DWR3	<b>ZK</b>	\$44	
2' x 8' Refrigerator Panel	#REP	<b>ZO</b>	\$97	
4' x 8' Island Panel	#IP8	<b>ZL</b>	\$106	

# CABINET ACCESSORIES

1	<input type="checkbox"/> Light Kit 3000	\$299.00
2	<input type="checkbox"/> Light Kit 4000	\$299.00
3	<input type="checkbox"/> Double Trash (35 qt trash can) Pull-Out for 18" Base	\$69.98
4	<input type="checkbox"/> Single Trash (35 qt trash can) Pull-Out for 15"-18" Base	\$42.98
5	<input type="checkbox"/> Trash Can (35 qt)	\$14.99
6	<input type="checkbox"/> Door Mount Kit (Option for Trash Pull-Out)	\$14.98
7	<input type="checkbox"/> Spice Rack for 15"-18" Wall	\$22.98
8	<input type="checkbox"/> Shelf Pull-Out for 15"-18" Base	\$39.98
9	<input type="checkbox"/> Cabinet Hardware Pull/Knobs	\$2.99 & Up
10	<input type="checkbox"/> Cabinet Bar Pull 10-Pack	\$29.99
11	<input type="checkbox"/> Shims	\$1.99 & \$5.99
12	<input type="checkbox"/> Inflatable Air Shims - 2 Pack	\$34.98

*Need a New Door?*

 **DOOR CLEARANCE CENTER**

**YOUR #1 SOURCE FOR DOORS**

- **HUNDREDS OF DOORS IN STOCK!**
- **LOCKSETS & HANDLES TOO!**
- **SAVE 30-70%!**
- **KEYLESS ENTRY!**