

DATE: \_\_\_\_\_ CUSTOMER NAME: \_\_\_\_\_ PHONE: \_\_\_\_\_  
 EMAIL: \_\_\_\_\_ WHEN DO YOU WANT TO PICK-UP? \_\_\_\_\_

**DOOR CLEARANCE CENTER**

# RAINIER Cabinet Order Form

- Durable plywood cabinet boxes
- Soft close drawers and doors
- In stock in local Houston warehouse, please allow 1-3 days to pull order
- RTA - ready to assemble
- Premium factory finish
- Full overlay

**\$2,498!**  
**10x10 SET**



**LIGHT GRAY**  
 SHAKER  
 (PAINTED)



Wall Cabinet - 1 DOOR			Qty
9" x 30"	#W930	<b>A</b>	\$137
12" x 30"	#W1230	<b>B</b>	\$138 *
15" x 30"	#W1530	<b>C</b>	\$152
18" x 30"	#W1830	<b>D</b>	\$158 **
21" x 30"	#W2130	<b>E</b>	\$173
9" x 36"	#W936	<b>WA</b>	\$150
12" x 36"	#W1236	<b>WB</b>	\$157
15" x 36"	#W1536	<b>WC</b>	\$169
18" x 36"	#W1836	<b>WD</b>	\$181
21" x 36"	#W2136	<b>WE</b>	\$192
9" x 42"	#W942	<b>UA</b>	\$161
12" x 42"	#W1242	<b>UB</b>	\$169
15" x 42"	#W1542	<b>UC</b>	\$184
18" x 42"	#W1842	<b>UD</b>	\$200
21" x 42"	#W2142	<b>UE</b>	\$212



Wall Cabinet - 2 DOORS			Qty
24" x 30"	#W2430	<b>F</b>	\$192
30" x 30"	#W3030	<b>H</b>	\$216
36" x 30"	#W3630	<b>J</b>	\$229 *
24" x 36"	#W2436	<b>WF</b>	\$215
30" x 36"	#W3036	<b>WH</b>	\$238
36" x 36"	#W3636	<b>WJ</b>	\$262
24" x 42"	#W2442	<b>UF</b>	\$242
30" x 42"	#W3042	<b>UH</b>	\$262
36" x 42"	#W3642	<b>UJ</b>	\$296



Wall Bridge Cabinet			Qty
30" x 12"	#W3012	<b>K</b>	\$146 *
36" x 12"	#W3612	<b>L</b>	\$156 *
30" x 18"	#W3018	<b>WK</b>	\$164
36" x 18"	#W3618	<b>WL</b>	\$178
30" x 24"	#W3024	<b>UK</b>	\$190
36" x 24"	#W3624	<b>UL</b>	\$210



Refrigerator Wall Cabinet - 24" DEEP			Qty
36" x 18"	#WR3618	<b>UM</b>	\$227
36" x 24"	#WR3624	<b>UN</b>	\$268



Diagonal Wall Corner Cabinet			Qty
24" x 30"	#DW2430	<b>O</b>	\$222 *
24" x 36"	#DW2436	<b>WO</b>	\$251
24" x 42"	#DW2442	<b>UO</b>	\$282

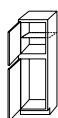

Tall Pantry Cabinet			Qty
18" x 84"	#P1884	<b>YH</b>	\$461
18" x 90"	#P1890	<b>YL</b>	\$480
18" x 96"	#P1896	<b>YM</b>	\$498

◊ Reversible 42" wide cabinet. Install 3"-6" away from wall for a 45"-48" wide space.

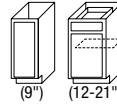

Base Cabinet - 1 DOOR				Qty
9"	#B9	<b>P</b>	\$188	*
12"	#B12	<b>Q</b>	\$197	
15"	#B15	<b>R</b>	\$200	*
18"	#B18	<b>S</b>	\$211	*
21"	#B21	<b>T</b>	\$229	

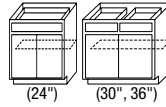

Base Cabinet - 2 DOORS				Qty
24"	#B24-2	<b>U</b>	\$281	
30"	#B30	<b>W</b>	\$311	
36"	#B36	<b>X</b>	\$344	



Drawer Base Cabinet				Qty
12"	#DB12	<b>YJ</b>	\$275	
15"	#DB15	<b>YA</b>	\$292	
18"	#DB18	<b>YB</b>	\$299	
24"	#DB24	<b>YC</b>	\$323	
30"	#DB30	<b>YK</b>	\$354	

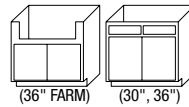

Sink Base Cabinet				Qty
30"	#SB30	<b>YD</b>	\$250	
36"	#SB36	<b>YE</b>	\$258	*
36" FARM	#SBF36	<b>YN</b>	\$264	



Blind Base Cabinet				Qty
45"-48"	#BBC42	<b>YF</b>	\$299	◊



Base Corner Cabinet - LAZY SUSAN				Qty
36"	#LS36	<b>YG</b>	\$434	*

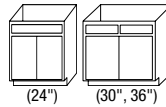

Vanity Sink Base Cabinet				Qty
24" x 21"	#V2421	<b>VB</b>	\$226	
30" x 21"	#V3021	<b>VC</b>	\$242	
36" x 21"	#V3621	<b>VD</b>	\$256	



Vanity Drawer Base Cabinet				Qty
12" x 21"	#VDB1221	<b>VA</b>	\$264	

**Accessories**

3" x 42" Filler	#F342	<b>ZM</b>	\$14
6" x 42" Filler	#F642	<b>ZN</b>	\$34
3" x 96" Tall Filler	#F396	<b>ZC</b>	\$52
8' Toe Kick	#TK8	<b>ZD</b>	\$16
8' Scribe Moulding	#SM8	<b>ZE</b>	\$12
8' Shoe Moulding	#SH8	<b>ZF</b>	\$18
8' Crown Moulding	#CM8	<b>ZG</b>	\$100
8' Outside Corner Moulding	#OCM8	<b>ZH</b>	\$29
3" Dishwasher End Panel	#DWR3	<b>ZK</b>	\$73
2.5' x 8' Refrigerator Panel	#REP3096	<b>ZO</b>	\$131
4' x 8' Island Panel	#IP8	<b>ZL</b>	\$127

\* INCLUDED IN \$2,498 10X10 SET

# CABINET ACCESSORIES

1	<input type="checkbox"/> Double Trash (35 qt trash can) Pull-Out for 18" Base	\$78.98
2	<input type="checkbox"/> Single Trash (35 qt trash can) Pull-Out for 15"-18" Base	\$68.98
3	<input type="checkbox"/> Trash Can (35 qt)	\$18.98
4	<input type="checkbox"/> Door Mount Kit (Option for trash can pull-out for single/double.)	\$15.98
5	<input type="checkbox"/> Shelf Pull-Out for 15"-18" Base	\$48.98
6	<input type="checkbox"/> Pull-Out Spice Rack	\$198.98
7	<input type="checkbox"/> Knobs & Pulls	\$4.00
8	<input type="checkbox"/> Cabinet Bar Pull 10-Pack	\$29.99
9	<input type="checkbox"/> Install Template for Knobs & Pulls	\$8.98
10	<input type="checkbox"/> Shims	\$1.99 & \$5.99
11	<input type="checkbox"/> Inflatable Air Shims - 2 Pack	\$34.98

*Need a New Door?*

 **DOOR CLEARANCE CENTER**

**YOUR #1 SOURCE FOR DOORS**

- **HUNDREDS OF DOORS IN STOCK!**
- **LOCKSETS & HANDLES TOO!**
- **SAVE 30-70%!**
- **KEYLESS ENTRY!**