

DATE: _____ CUSTOMER NAME: _____ PHONE: _____
 EMAIL: _____ WHEN DO YOU WANT TO PICK-UP? _____

DOOR CLEARANCE CENTER

BRADLEY Cabinet Order Form

- Frameless cabinet case
- Scratch resistant TSS melamine slab doors
- 3/4" 11-ply birch plywood case and shelves
- Natural maple wrap prevents stains and assists with waterproofing
- Soft-close hinges and drawers
- Solid wood drawers with dovetail assembly
- RTA - ready to assemble
- Get it fast! Allow approx. 2 weeks

\$2,498!
10x10 SET



GRAY BIRCH
GB



WEATHERED ASPEN
WA



WEATHERED OAK
WO



ANTIQUE WALNUT
AW

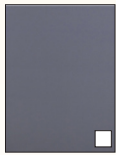

BRILLO GRAY
BG



MIST WHITE
MW



RAIN CHERRY
RC



Wall Cabinet – 1 DOOR			Qty
9" x 30"	#W0930	\$124	
12" x 30"	#W1230	\$113	*
15" x 30"	#W1530	\$153	
18" x 30"	#W1830	\$148	**
21" x 30"	#W2130	\$194	
9" x 36"	#W936	\$136	
12" x 36"	#W1236	\$152	
15" x 36"	#W1536	\$174	
18" x 36"	#W1836	\$199	
21" x 36"	#W2136	\$220	
9" x 42"	#W0942	\$151	
12" x 42"	#W1242	\$173	
15" x 42"	#W1542	\$197	
18" x 42"	#W1842	\$222	
21" x 42"	#W2142	\$246	



Wall Cabinet – 2 DOORS			Qty
24" x 30"	#W2430	\$220	
30" x 30"	#W3030	\$259	
36" x 30"	#W3630	\$251	*
24" x 36"	#W2436	\$261	
30" x 36"	#W3036	\$306	
36" x 36"	#W3636	\$353	
24" x 42"	#W2442	\$299	
30" x 42"	#W3042	\$348	
36" x 42"	#W3642	\$396	



Wall Bridge Cabinet			Qty
30" x 12"	#W3012	\$119	*
36" x 12"	#W3612	\$134	*
30" x 18"	#W3018	\$166	
36" x 18"	#W3618	\$195	
30" x 24"	#W3024	\$219	
36" x 24"	#W3624	\$231	



Refrigerator Wall Cabinet – 24" DEEP			Qty
36" x 18"	#W361824	\$320	
36" x 24"	#W362424	\$421	



Wall Corner Cabinet			Qty
24" x 30"	#WER2430	\$251	*
24" x 36"	#WER2436	\$360	
24" x 42"	#WER2442	\$420	

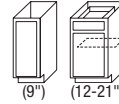

Base Cabinet – 1 DOOR			Qty
9"	#BF09	\$165	*
12"	#B12	\$234	
15"	#B15	\$214	*
18"	#B18	\$230	*
21"	#B21	\$292	



Base Cabinet – 2 DOORS			Qty
24"	#B24	\$338	
30"	#B30	\$389	
36"	#B36	\$441	



Drawer Base Cabinet			Qty
12"	#DB12	\$407	
15"	#DB15	\$415	
18"	#DB18	\$433	
24"	#DB24	\$484	
30"	#DB30	\$497	



Sink Base Cabinet			Qty
30"	#SB30	\$264	
36"	#SB36	\$241	*



Blind Base Cabinet			Qty
45"-48"	#BBC42	\$447	



Base Corner Cabinet – LAZY SUSAN			Qty
36"	#LS36	\$485	*

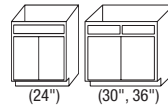

Vanity Sink Base Cabinet			Qty
24" x 21"	#V2421	\$265	
30" x 21"	#V3021	\$309	
36" x 21"	#V3621	\$371	



Vanity Drawer Base Cabinet			Qty
12" x 21"	#VDB1221	\$383	

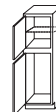

Tall Pantry Cabinet			Qty
18" x 84"	#WP1884	\$570	
18" x 90"	#WP1890	\$615	
18" x 96"	#WP1896	\$663	

Accessories

Accessories			Qty
3" Wall Filler	#WF330/336/342	\$15	
6" Wall Filler	#WF630/636/642	\$30	
3" Tall Filler	#TF384/390/396	\$62	
Wall End Panel (3/4")	#WEP30/36/42	\$26	
Vanity End Panel (3/4")	#VEP	\$45	
Base End Panel (3/4")	#BEP	\$45	
Tall End Panel (3/4")	#TEP2496	\$150	
Dishwasher End Panel	#DEP3	\$69	
Island Panel (34.5" x 96" x 3/4")	#PNL3496	\$179	
8" Toe Kick	#TK8	\$24	
8" Scribe Moulding	#SM8	\$14	
8" Outside Corner Moulding	#OM8	\$24	

* INCLUDED IN \$2,498 10X10 SET

CABINET ACCESSORIES

1	<input type="checkbox"/> Double Trash (35 qt trash can) Pull-Out for 18" Base	\$78.98
2	<input type="checkbox"/> Single Trash (35 qt trash can) Pull-Out for 15"-18" Base	\$68.98
3	<input type="checkbox"/> Trash Can (35 qt)	\$18.98
4	<input type="checkbox"/> Door Mount Kit (Option for trash can pull-out for single/double.)	\$15.98
5	<input type="checkbox"/> Shelf Pull-Out for 15"-18" Base	\$48.98
6	<input type="checkbox"/> Pull-Out Spice Rack	\$198.98
7	<input type="checkbox"/> Knobs & Pulls	\$4.00
8	<input type="checkbox"/> Cabinet Bar Pull 10-Pack	\$29.99
9	<input type="checkbox"/> Install Template for Knobs & Pulls	\$8.98
10	<input type="checkbox"/> Shims	\$1.99 & \$5.99
11	<input type="checkbox"/> Inflatable Air Shims - 2 Pack	\$34.98

Need a New Door?

 **DOOR CLEARANCE CENTER**

YOUR #1 SOURCE FOR DOORS

- **HUNDREDS OF DOORS IN STOCK!**
- **LOCKSETS & HANDLES TOO!**
- **SAVE 30-70%!**
- **KEYLESS ENTRY!**