

DATE: _____ CUSTOMER NAME: _____ PHONE: _____
 EMAIL: _____ WHEN DO YOU WANT TO PICK-UP? _____

DOOR CLEARANCE CENTER

ULYSSES² Cabinet Worksheet

- All plywood, no particle board
- Solid hardwood face frames
- High quality factory finish
- Premium features
- RTA - ready to assemble

\$1,998!
10x10 SET



SHAKER GRAY



SHAKER RUSTIC



SHAKER ESPRESSO



PREMIUM GRAY





ANTIQUÉ CHOCOLATE





ANTIQUÉ MOCHA

| Wall Cabinet – 1 DOOR | | | Qty |
|---|------------------|-------|-----|
|  | 9" x 30" #W0930 | \$113 | |
| | 12" x 30" #W1230 | \$90 | * |
| | 15" x 30" #W1530 | \$139 | |
| | 18" x 30" #W1830 | \$118 | ** |
| | 21" x 30" #W2130 | \$176 | |
| | 9" x 36" #W936 | \$124 | |
| | 12" x 36" #W1236 | \$138 | |
| | 15" x 36" #W1536 | \$158 | |
| | 18" x 36" #W1836 | \$181 | |
| | 21" x 36" #W2136 | \$200 | |
| | 9" x 42" #W0942 | \$137 | |
| | 12" x 42" #W1242 | \$157 | |
| | 15" x 42" #W1542 | \$179 | |
| | 18" x 42" #W1842 | \$202 | |
| | 21" x 42" #W2142 | \$224 | |



| Wall Cabinet – 2 DOORS | | | Qty |
|---|------------------|-------|-----|
|  | 24" x 30" #W2430 | \$200 | |
| | 30" x 30" #W3030 | \$235 | |
| | 36" x 30" #W3630 | \$201 | * |
| | 24" x 36" #W2436 | \$237 | |
| | 30" x 36" #W3036 | \$278 | |
| | 36" x 36" #W3636 | \$321 | |
| | 24" x 42" #W2442 | \$272 | |
| | 30" x 42" #W3042 | \$316 | |
| | 36" x 42" #W3642 | \$360 | |

| Wall Bridge Cabinet | | | Qty |
|---|------------------|-------|-----|
|  | 30" x 12" #W3012 | \$95 | * |
| | 36" x 12" #W3612 | \$107 | * |
| | 30" x 18" #W3018 | \$151 | |
| | 36" x 18" #W3618 | \$177 | |
| | 30" x 24" #W3024 | \$199 | |
| | 36" x 24" #W3624 | \$210 | |

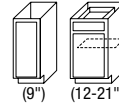

| Refrigerator Wall Cabinet – 24" DEEP | | | Qty |
|---|-------------------|-------|-----|
|  | 36" x 18" #WR3618 | \$291 | |
| | 36" x 24" #WR3624 | \$383 | |

| Diagonal Wall Corner Cabinet | | | Qty |
|---|--------------------|-------|-----|
|  | 24" x 30" #WDC2430 | \$201 | * |
| | 24" x 36" #WDC2436 | \$327 | |
| | 24" x 42" #WDC2442 | \$382 | |

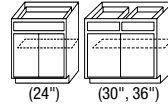

| Base Cabinet – 1 DOOR | | | Qty |
|---|----------|-------|-----|
|  | 9" #TB09 | \$132 | * |
|  | 12" #B12 | \$213 | |
| | 15" #B15 | \$171 | * |
| | 18" #B18 | \$184 | * |
| | 21" #B21 | \$265 | |



| Base Cabinet – 2 DOORS | | | Qty |
|--|----------|-------|-----|
|  | 24" #B24 | \$307 | |
|  | 30" #B30 | \$354 | |
| | 36" #B36 | \$401 | |



| Drawer Base Cabinet | | | Qty |
|---|-----------|-------|-----|
|  | 12" #DB12 | \$370 | |
| | 15" #DB15 | \$377 | |
| | 18" #DB18 | \$394 | |
| | 24" #DB24 | \$440 | |
| | 30" #DB30 | \$452 | |



| Sink Base Cabinet | | | Qty |
|--|-----------|-------|-----|
|  | 33" #SB33 | \$240 | |
| | 36" #SB36 | \$193 | * |





| Blind Base Cabinet | | | Qty |
|--|------------|-------|-----|
|  | 36" #BBC36 | \$406 | |

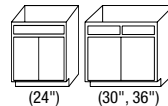

| Base Corner Cabinet – LAZY SUSAN | | | Qty |
|--|-------------|-------|-----|
|  | 36" #LS3612 | \$388 | * |



| Vanity Sink Base Cabinet | | | Qty |
|--|------------------|-------|-----|
|  | 24" x 21" #V2421 | \$241 | |
|  | 30" x 21" #V3021 | \$281 | |
| | 36" x 21" #V3621 | \$337 | |



| Vanity Drawer Base Cabinet | | | Qty |
|---|--------------------|-------|-----|
|  | 12" x 21" #VDB1221 | \$348 | |

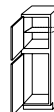

| Tall Pantry Cabinet | | | Qty |
|---|-------------------|-------|-----|
|  | 18" x 84" #UC1884 | \$518 | |
| | 18" x 90" #UC1890 | \$559 | |
| | 18" x 96" #UC1896 | \$603 | |

| Accessories | | | Qty |
|-------------|-------------------------------------|-------|-----|
| | 3" x 42" Filler #WF342 | \$17 | |
| | 6" x 42" Filler #WF642 | \$31 | |
| | 3" x 96" Tall Filler #TF396 | \$56 | |
| | 8' Toe Kick #TK8 | \$22 | |
| | 8' Scribe Moulding #SM8 | \$13 | |
| | 8' Large Crown Moulding #LCM8 | \$102 | |
| | 8' Outside Corner Moulding #OCS8 | \$22 | |
| | 3" Dishwasher End Panel #BEP3 | \$63 | |
| | 2' x 8' Refrigerator Panel #REF9624 | \$145 | |
| | 3' x 8' Island Panel #IS3696 | \$163 | |

* = part of our 10x10 special price set

CABINET ACCESSORIES

| | | |
|----|---|-----------------|
| 1 | <input type="checkbox"/> Light Kit 3000 | \$299.00 |
| 2 | <input type="checkbox"/> Light Kit 4000 | \$299.00 |
| 3 | <input type="checkbox"/> Double Trash (35 qt trash can) Pull-Out for 18" Base | \$69.98 |
| 4 | <input type="checkbox"/> Single Trash (35 qt trash can) Pull-Out for 15"-18" Base | \$42.98 |
| 5 | <input type="checkbox"/> Trash Can (35 qt) | \$14.99 |
| 6 | <input type="checkbox"/> Door Mount Kit (Option for Trash Pull-Out) | \$14.98 |
| 7 | <input type="checkbox"/> Spice Rack for 15"-18" Wall | \$22.98 |
| 8 | <input type="checkbox"/> Shelf Pull-Out for 15"-18" Base | \$39.98 |
| 9 | <input type="checkbox"/> Cabinet Hardware Pull/Knobs | \$2.99 & Up |
| 10 | <input type="checkbox"/> Cabinet Bar Pull 10-Pack | \$29.99 |
| 11 | <input type="checkbox"/> Shims | \$1.99 & \$5.99 |
| 12 | <input type="checkbox"/> Inflatable Air Shims - 2 Pack | \$34.98 |

Need a New Door?

 **DOOR CLEARANCE CENTER**

YOUR #1 SOURCE FOR DOORS

- **HUNDREDS OF DOORS IN STOCK!**
- **LOCKSETS & HANDLES TOO!**
- **SAVE 30-70%!**
- **KEYLESS ENTRY!**