

DATE: _____ CUSTOMER NAME: _____ PHONE: _____
 EMAIL: _____ WHEN DO YOU WANT TO PICK-UP? _____

DOOR CLEARANCE CENTER

BRADLEY Cabinet Order Form

- Frameless cabinet case
- Scratch resistant TSS melamine slab doors
- 3/4" 11-ply birch plywood case and shelves
- Natural maple wrap prevents stains and assists with waterproofing
- Soft-close hinges and drawers
- Solid wood drawers with dovetail assembly
- RTA - ready to assemble
- In stock in our warehouse, allow approx. 2-3 days to pull order

**MAY SPECIAL
20% OFF!**

TAKE 20% OFF THESE PRICES
MAY1 – MAY 31, 2021



**RAIN CHERRY
RC**



**ANTIQUE WALNUT
AW**



**WEATHERED OAK
WO**

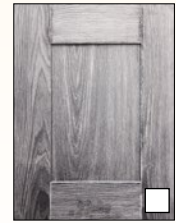



**GRAY BIRCH
GB**





**WEATHERED ASPEN
WA**

Wall Cabinet – 1 DOOR			Qty
	9" x 30" #W0930	\$124	_____
	12" x 30" #W1230	\$113	_____*
	15" x 30" #W1530	\$153	_____
	18" x 30" #W1830	\$148	_____**
	21" x 30" #W2130	\$194	_____
	9" x 36" #W936	\$136	_____
	12" x 36" #W1236	\$152	_____
	15" x 36" #W1536	\$174	_____
	18" x 36" #W1836	\$199	_____
	21" x 36" #W2136	\$220	_____
	9" x 42" #W0942	\$151	_____
	12" x 42" #W1242	\$173	_____
	15" x 42" #W1542	\$197	_____
	18" x 42" #W1842	\$222	_____
	21" x 42" #W2142	\$246	_____



Wall Cabinet – 2 DOORS			Qty
	24" x 30" #W2430	\$220	_____
	30" x 30" #W3030	\$259	_____
	36" x 30" #W3630	\$251	_____*
	24" x 36" #W2436	\$261	_____
	30" x 36" #W3036	\$306	_____
	36" x 36" #W3636	\$353	_____
	24" x 42" #W2442	\$299	_____
	30" x 42" #W3042	\$348	_____
	36" x 42" #W3642	\$396	_____

Wall Bridge Cabinet			Qty
	30" x 12" #W3012	\$119	_____*
	36" x 12" #W3612	\$134	_____*
	30" x 18" #W3018	\$166	_____
	36" x 18" #W3618	\$195	_____
	30" x 24" #W3024	\$219	_____
	36" x 24" #W3624	\$231	_____

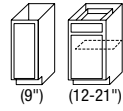

Refrigerator Wall Cabinet – 24" DEEP			Qty
	37" x 18" #W371824	\$320	_____
	37" x 24" #W372424	\$421	_____

Diagonal Wall Corner Cabinet			Qty
	24" x 30" #WDC2430	\$251	_____*
	24" x 36" #WDC2436	\$360	_____
	24" x 42" #WDC2442	\$420	_____

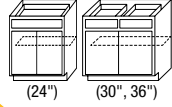

Base Cabinet – 1 DOOR			Qty
	9" #BF09	\$165	_____*
	12" #B12	\$234	_____
	15" #B15	\$214	_____*
	18" #B18	\$230	_____*
	21" #B21	\$292	_____



Base Cabinet – 2 DOORS			Qty
	24" #B24	\$338	_____
	30" #B30	\$389	_____
	36" #B36	\$441	_____



Drawer Base Cabinet			Qty
	12" #DB12	\$407	_____
	15" #DB15	\$415	_____
	18" #DB18	\$433	_____
	24" #DB24	\$484	_____
	30" #DB30	\$497	_____



Sink Base Cabinet			Qty
	30" #SB30	\$264	_____
	36" #SB36	\$241	_____*





Blind Base Cabinet			Qty
	42" x 45" #BBC42/45	\$447	_____

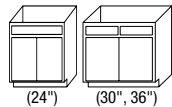

Base Corner Cabinet – LAZY SUSAN			Qty
	36" #LS36	\$485	_____*



Vanity Sink Base Cabinet			Qty
	24" x 21" #V2421	\$265	_____
	30" x 21" #V3021	\$309	_____
	36" x 21" #V3621	\$371	_____



Vanity Drawer Base Cabinet			Qty
	12" x 21" #VDB1221	\$383	_____

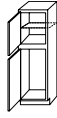

Tall Pantry Cabinet			Qty
	18" x 84" #WP1884	\$570	_____
	18" x 90" #WP1890	\$615	_____
	18" x 96" #WP1896	\$663	_____

Accessories			Qty
	3" x 30" Filler #WF330	\$12	_____
	3" x 42" Filler #WF342	\$19	_____
	6" x 30" Filler #WF630	\$23	_____
	6" x 42" Filler #WF642	\$34	_____
	3" x 96" Tall Filler #WF396	\$62	_____
	8' Toe Kick #TK8	\$24	_____
	8' Scribe Moulding #SM8	\$14	_____
	8' Shoe Moulding #SHM8	\$33	_____
	8' Crown Moulding #CM8	\$62	_____
	8' Large Crown Moulding #LCM8	\$112	_____
	8' Outside Corner Moulding #OM8	\$24	_____
	3" Dishwasher End Panel #DWR3	\$69	_____
	2' x 8' Refrigerator Panel #REF2496	\$160	_____
	3' x 8' Island Panel #PNL1/2x36x96	\$179	_____